



IKA PEN Electronic Pipette

IKA

designed for scientists

Accessories



PEN.Stand
Ident. No. 20133075

PEN.WiCo
Ident. No. 20118751

PEN.HD1
Ident. No. 20104002

PEN.HD2
Ident. No. 20104003

Choose from different handles for optimal user comfort

202601_IKA PEN_flyer_IWS_EN_94000777

IKA



Redefining Liquid Handling
IKA PEN

IKA-Werke GmbH & Co. KG
Janke & Kunkel-Straße 10, 79219 Staufen, Germany
Phone: +49 7633 831-0, eMail: sales@ika.de
www.ika.com

f X @ in v
IKAworlwide // #lookattheblue

IKA PEN

/// Lightweight precision meets smart innovation

Discover the perfect balance of comfort and control with our ultra-light electronic pipette – IKA PEN – weighing just 100 grams with a noise level of only 36.9 dB. This makes it one of the lightest and quietest electronic pipettes on the market. With its slim, ergonomic profile and modern design, our electronic pipette combines precision with style – featuring an intuitive, pen-shaped design for effortless handling and a natural grip. Designed for fatigue-free operation, it's the ideal companion for long lab sessions without compromising precision.



Choose the volume that fits your workflow

Available in four different ranges:

IKA PEN 0.5 – 10 µl
Ident. No. 0020025101

IKA PEN 5 – 100 µl
Ident. No. 0020025102

IKA PEN 10 – 200 µl
Ident. No. 0020025103

IKA PEN 50 – 1000 µl (coming soon)
Ident. No. 0020140238



Powered by a rechargeable lithium battery, the pipette can be operated for one full working day on a single charge, with a quick 1 hour* recharge time via USB-C.

*1h fast charge to 70%.

2+1
Year
Warranty*

*1 year extra after device registration

It features the **smallest motor and display** in its class, yet offers **powerful functionality** through programmable settings and seamless Bluetooth connectivity to an intuitive app interface.

IKA PEN App

The app enhances usability with a larger display and simplified controls, making precision pipetting easier than ever.



Original size

Menu Features

/// Smart control at your fingertips

Take full command of your pipetting workflow with an intuitive **program sub-menu** that adapts to your needs. Adjust the **SPEED** across nine levels for optimal control, activate the **MIX** function to continuously aspirate and dispense a set volume for thorough sample blending, or use the **COUNTER** to keep track of your pipetting cycles with ease.

Additional smart features enhance your experience even further. With **ADJUST**, you can perform self-calibration at 1, 2 or 3 points for consistent accuracy.

The **WIRELESS** function helps you quickly locate nearby Bluetooth devices for seamless connectivity, while **CUT** allows you to disconnect with a single tap when needed.

BENEFITS

- › Ultra-light with only 100 gramms
- › Very quiet with a noise level of only 36.9 dB
- › Better accuracy and precision
- › Improved ergonomics
- › Intuitive user interface – only minimal training required
- › Time-saving
- › Reproducibility and traceability
- › Easy and straightforward self-calibration feature
- › Simplify complex pipetting protocols



Watch IKA PEN video

PEN MODES

- PIP** Pipette a set volume
 - › Fill and dispense a set volume of liquid
- REV** Reverse pipetting
 - › Fill and dispense a set volume of viscous liquid
 - › Take up an excess volume
- MUL** Multi-dispense
 - › Dispense set volume multiple times
 - › Number of repetitions dependent on the max volume the pipette can aspirate
- DIL** Dilute two liquids
 - › Make a dilution from two different liquids
 - › Two different liquids are aspirated one after the other into the same tip
- MAN** Manual volume measurement
 - › Fill and dispense a flexible volume of liquid (no set volume)
 - › The pipetting button is pressed until sufficient liquid is aspirated and the volume is measured

User Interface

/// Easy handling thanks to intuitive menu structure

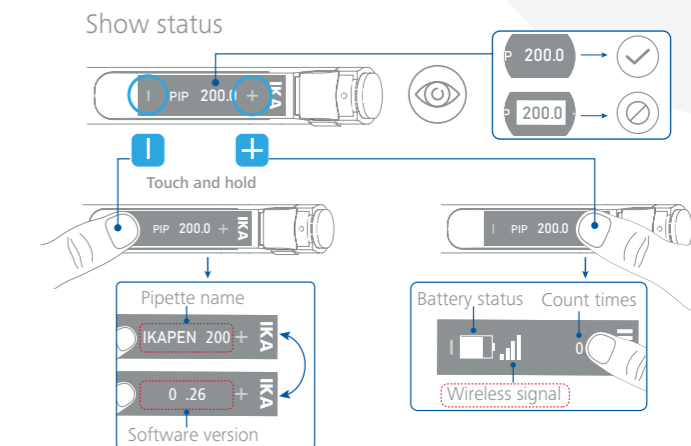

Flip the display

For right or left handed users for optimal visibility in any position. Or check your pipetting status instantly by touching and holding the + or - sign – perfect for dynamic lab environments.

Navigate with ease

Clear menu structure with symbols like + and - make operation straightforward, even during complex protocols.

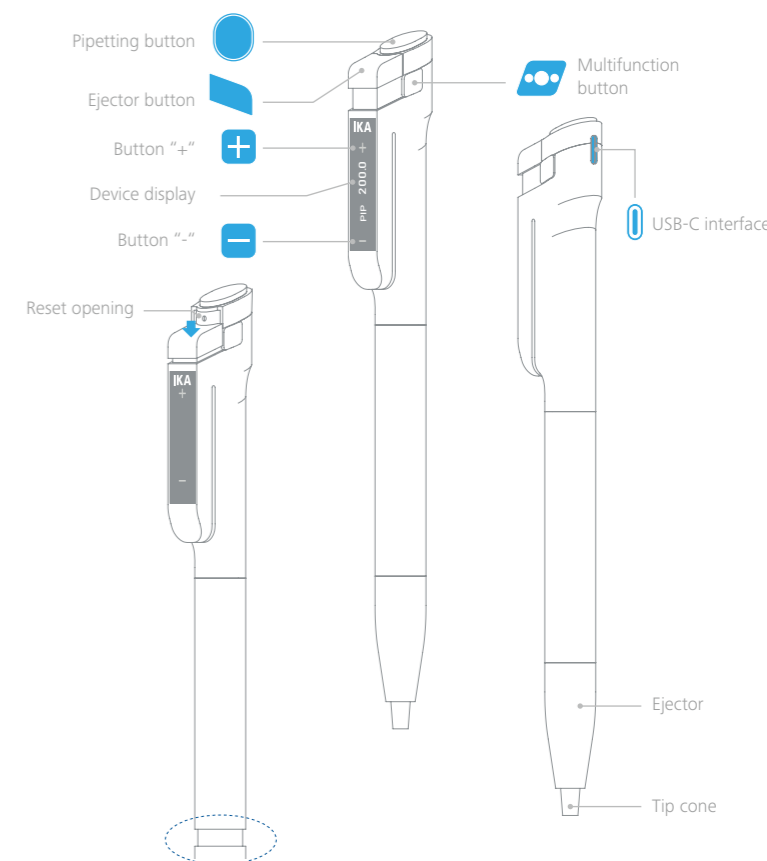

Work comfortably

with an ergonomic design that fits naturally in your hand, reducing fatigue during repetitive tasks.

Trust your results

with consistent, high-precision performance every time.